

Tube connectors for polyamide hoses and polyurethane hoses made of brass CW617N and acetal copolymer (POM).

Temperature range -10 °C to +60 °C
Max. working pressure 10 bar

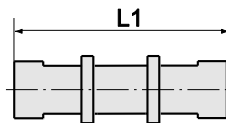

RTU-6-6

Hose connector, brass

Art. No.	Type No.	For hose mm	L1 mm
133400	RTU-2-2	I.D. 2	14.0
133401	RTU-3-3	I.D. 3	19.0
133402	RTU-4-4	I.D. 4	23.0
133403	RTU-6-6	I.D. 6	28.0

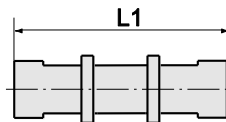

RTU-6-4

Hose connector, unequal, brass

Art. No.	Type No.	For hose mm	L1 mm
133404	RTU-3-2	I.D. 3/2	18.0
133405	RTU-4-3	I.D. 4/3	20.0
133406	RTU-6-4	I.D. 6/4	25.5

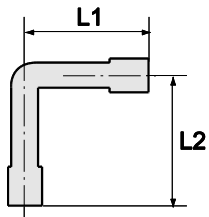

LPK-600

Elbow hose connectors, brass and POM

Art. No.	Type No.	For hose mm	L1 mm	L2 mm
133407	LPK-300	I.D. 3	15.3	15.3
133408	LPK-400	I.D. 4	18.7	18.7
133409	LPK-600	I.D. 6	25.8	25.8

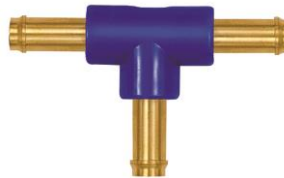
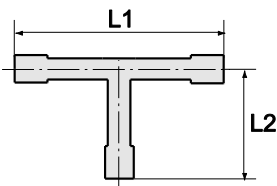

TPK-600

Tee hose connectors, brass and POM

Art. No.	Type No.	For hose mm	L1 mm	L2 mm
133410	TPK-300	I.D. 3	30.6	15.3
133411	TPK-400	I.D. 4	37.3	18.7
133412	TPK-600	I.D. 6	51.6	25.8

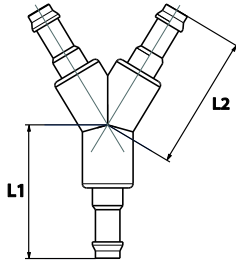

YPK-600

Y-hose connectors, brass and POM

Art. No.	Type No.	For hose mm	L1 mm	L2 mm
133413	YPK-300	I.D. 3	15.9	15.9
133414	YPK-400	I.D. 4	20.2	20.2
133415	YPK-600	I.D. 6	24.0	29.0

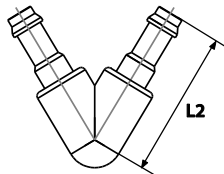

VPK-600

V-hose connectors, brass and POM

Art. No.	Type No.	For hose mm	L2 mm
133416	VPK-300	I.D. 3	15.9
133417	VPK-400	I.D. 4	20.2
133418	VPK-600	I.D. 6	30.0